

# FRANKE FILTERFLOW

## Changing the Cartridge - Stainless Steel Housings

### Cartridge Replacement Cycle

The recommended filter cartridge change cycle is 6 months.

**IMPORTANT.** The period between cartridge replacements is not guaranteed; it is an estimate based on filtering mains water of average quality. Please bear in mind that water quality varies from locality to locality and situation to situation. In areas with higher than average turbidity (particle contamination) more frequent cartridge changes may be necessary.

Before you Begin. No special tools are required for this operation. All you will need is a suitable receptacle to catch any spillage and a cloth or a sponge handy.

**Lubricating the Rubber Seals.** For ease of assembly we recommend that a film of silicon grease is applied to the filter housing 'O' Seal at least every other cartridge change to maintain the smooth operation of the unit.

**IMPORTANT.** Only a WRAS approved silicone lubricant should be used for this purpose.

Small tubes of a WRAS approved silicone grease can be purchased from [www.grldirect.co.uk](http://www.grldirect.co.uk)

**Disposing of the Spent Cartridge.** You may dispose of the cartridge in your normal household waste. The ceramic and carbon components of the filter cartridges are biodegradable. However, your local council recycling facilities are unable to recycle them. You are welcome to return your cartridge to GRL Direct for recycling but we do ask that you cover the return postage. If you wish to do this, simply allow the old cartridge to dry naturally, repack it in the new cartridge packaging and return it to GRL Direct.

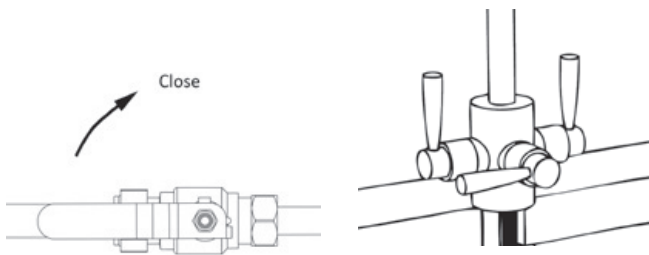

1. Locate the shut-off valve and turn off the mains water supply to the filter housing.

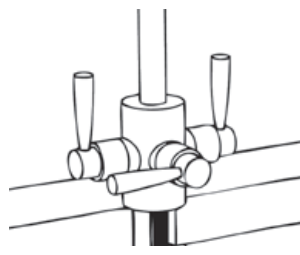

2. Turn on the dispenser to release the pressure in the system. Leave the tap in the 'on' position.\*

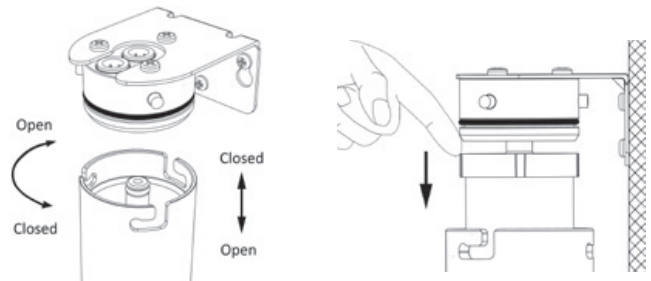

3. The filter cartridge housing will be full of water, so ensure you have a bowl to hand to catch any spills. Turn the lower section (the sump) of the housing to the left and pull down. The sump and the filter cartridge should come away together.

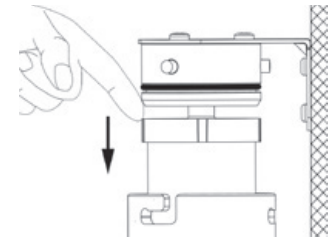

4. If the filter cartridge does not come away with the sump release it with an index finger by pushing down on the plastic rim.



5. Holding the sump over the sink remove the spent cartridge and empty the water in the sump. Dispose of the spent cartridge. Wet the 'O' seal and then place the new cartridge in the sump.

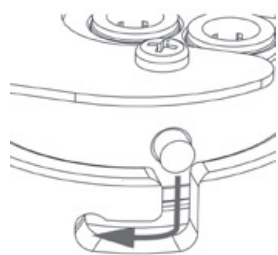

6. Refit the sump to the housing head by engaging the pins in the slots and turning the sump to the right until it is fully engaged.

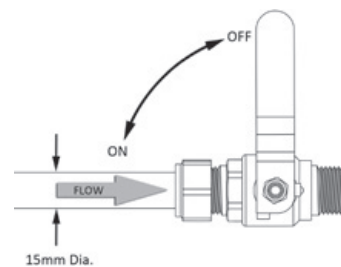

7. Turn the water supply 'on' and check the system carefully for leaks. Leave the filter tap in the 'on' position and allow the water to run for approximately 10 minutes to flush the system. **IMPORTANT NOTE:** The optimum flow rate is 2 litres per minute. The performance of the filter will be negatively affected if the flow rate is too fast. If necessary the flow rate can be regulated by adjusting the stop valve.

**\*IMPORTANT.** If the tap is not left 'on' the pressure trapped in the system will make it impossible to unlock the filter housing sump from the head.



GRL Direct  
+44 (0)1603 875468  
support@grldirect.co.uk  
[www.grldirect.co.uk](http://www.grldirect.co.uk)